

Векторный инвертор LD500

Технические характеристики

По вопросам продаж и поддержки обращайтесь:

Алматы (727)345-47-04
Ангарск (3955)60-70-56
Архангельск (8182)63-90-72
Астрахань (8512)99-46-04
Барнаул (3852)73-04-60
Белгород (4722)40-23-64
Благовещенск (4162)22-76-07
Брянск (4832)59-03-52
Владивосток (423)249-28-31
Владикавказ (8672)28-90-48
Владимир (4922)49-43-18
Волгоград (844)278-03-48
Вологда (8172)26-41-59
Воронеж (473)204-51-73
Екатеринбург (343)384-55-89

Иваново (4932)77-34-06
Ижевск (3412)26-03-58
Иркутск (395)279-98-46
Казань (843)206-01-48
Калининград (4012)72-03-81
Калуга (4842)92-23-67
Кемерово (3842)65-04-62
Киров (8332)68-02-04
Коломна (4966)23-41-49
Кострома (4942)77-07-48
Краснодар (861)203-40-90
Красноярск (391)204-63-61
Курск (4712)77-13-04
Курган (3522)50-90-47
Липецк (4742)52-20-81

Магнитогорск (3519)55-03-13
Москва (495)268-04-70
Мурманск (8152)59-64-93
Набережные Челны (8552)20-53-41
Нижний Новгород (831)429-08-12
Новокузнецк (3843)20-46-81
Ноябрьск (3496)41-32-12
Новосибирск (383)227-86-73
Омск (3812)21-46-40
Орел (4862)44-53-42
Оренбург (3532)37-68-04
Пенза (8412)22-31-16
Петрозаводск (8142)55-98-37
Псков (8112)59-10-37
Пермь (342)205-81-47

Ростов-на-Дону (863)308-18-15
Рязань (4912)46-61-64
Самара (846)206-03-16
Санкт-Петербург (812)309-46-40
Саратов (845)249-38-78
Севастополь (8692)22-31-93
Саранск (8342)22-96-24
Симферополь (3652)67-13-56
Смоленск (4812)29-41-54
Сочи (862)225-72-31
Ставрополь (8652)20-65-13
Сургут (3462)77-98-35
Сыктывкар (8212)25-95-17
Тамбов (4752)50-40-97
Тверь (4822)63-31-35

Тольятти (8482)63-91-07
Томск (3822)98-41-53
Тула (4872)33-79-87
Тюмень (3452)66-21-18
Ульяновск (8422)24-23-59
Улан-Удэ (3012)59-97-51
Уфа (347)229-48-12
Хабаровск (4212)92-98-04
Чебоксары (8352)28-53-07
Челябинск (351)202-03-61
Череповец (8202)49-02-64
Чита (3022)38-34-83
Якутск (4112)23-90-97
Ярославль (4852)69-52-93

Россия +7(495)268-04-70

Казахстан +7(727)345-47-04

Беларусь +375-257-127-884

Узбекистан +998(71)205-18-59

Киргизия +996(312)96-26-47

эл.почта: agy@nt-rt.ru || сайт: <https://laeg.nt-rt.ru>

LD500 Series General Vector Inverter

LD500 series is a newly upgraded design of high-performance vector inverter with modular and rationalized layout of internal parts and blade-type narrow body design in appearance, which is compatible with the control of permanent magnet synchronous and asynchronous motors, and at the same time has the characteristics of high performance and high reliability. With rich expansion interfaces and expansion cards, it can be interconnected with PLC, industrial control machine and other automation equipment.

Quantity:



Performance Characteristics:

1. New blade design, the continuation of the previous generation of high overload and high precision at the same time, to achieve the horizontal surface reduction, which is conducive to space-saving, convenient for users to install and use;
2. With advanced motor parameters self-learning function, support for asynchronous and synchronous motors;
3. 8-way multi-function input terminals, with 52 kinds of customized terminal functions, to achieve flexible multi-function control;
4. Timing operation function, timing operation can be up to 6500Min; with pendulum frequency control function, pendulum frequency function parameters can be adjusted by the user; built-in simple PLC, programmable 16-segment speed operation, each section of the running time, acceleration and deceleration time are independently adjustable.

LD500 series General vector inverter

LD500 E - 7R5 G - T4 B

Frequency converter series
Universal vector series

无	Standard series
K	Special for air compressor
W	Special for constant pressure water supply
E	Permanent magnet synchronization

2R2	2.2kW
011	11kW
200	200kW

B	Built-in braking unit
C	Cabinet machine with base
D	Built-in reactor

S2	Single phase 220V
T2	Three-phase 220V
T4	Three-phase 380V

G	Constant torque load
P	Variable torque light load (Fan water pump type)

LD500 () T4	030	037	045	055	075	090	110	132	160	185	200	220
KW	30	37	45	55	75	90	110	132	160	185	200	220
Frame size	E		F			G		H		I		

LD500 () T4	250	280	315	355	400	450	500	560	
KW	250	280	315	355	400	450	500	560	
Frame size	J		K			L			



▶ Frame size E

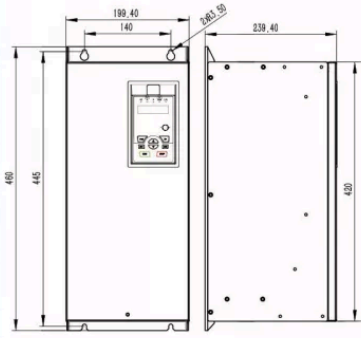

LD500-30G-T4
LD500-37G-T4

Frame size F

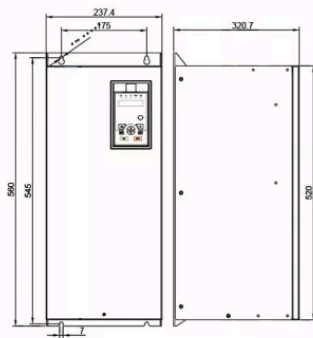

LD500-45G-T4
LD500-55G-T4
LD500-75G-T4

Frame size G

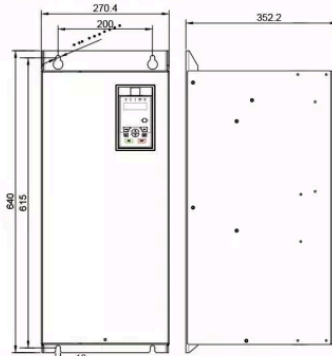

LD500-90G-T4
LD500-110G-T4

(Unit:mm)

▶ Frame size H

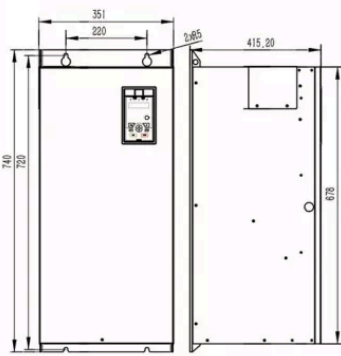

LD500-132G-T4
LD500-160G-T4

Frame size I

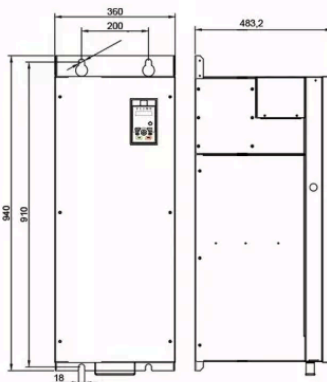

LD500-185G-T4
LD500-200G-T4
LD500-220G-T4

Frame size J

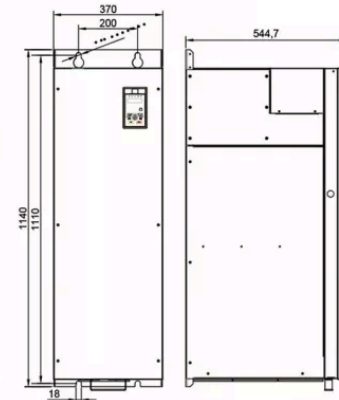

LD500-250G-T4
LD500-280G-T4

(Unit:mm)

▶ Frame size K

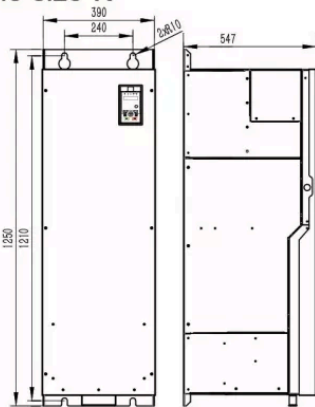

LD500-315G-T4
LD500-355G-T4
LD500-400G-T4

Frame size L

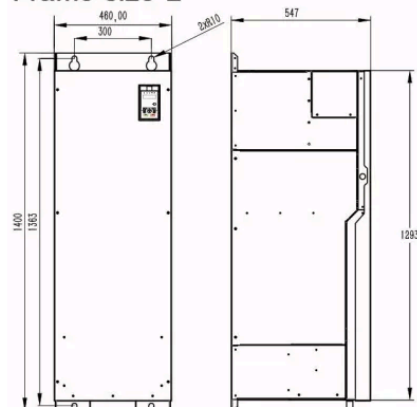

LD500-450G-T4
LD500-500G-T4
LD500-560G-T4

(Unit:mm)

Three-phase 380V												
Frame size		E		F			G		H		I	
Type LD500- T4		030	037	045	055	075	090	110	132	160	185	200
Applicable motor power KW		30	37	45	55	75	90	110	132	160	185	200
Applicable motor horsepower HP		40	50	60	75	100	125	150	180	220	250	275
output	Rated output capacity KVA	40	57	69	85	114	134	160	192	231	244	250
	Rated output current A	60	75	91	112	150	176	210	253	304	340	377
	Output frequency Hz	0.01--400Hz										
	Carrier frequency range KHz	1--16KHz										
	Overload capacity	150% of rated output current, can withstand 60S 200% of rated output current, can withstand 3S										
input	Input current A	62	76	92	113	157	180	214	256	307	350	385
	Input voltage frequency	AC:three-phase 380V.50/60Hz										
	Permissible voltage fluctuations	(-15%--+15%)										
Cooling system		Forced cold air										

Three-phase 380V										
Frame size		I	J		K			L		
Type LD500- T4		220	250	280	315	355	400	450	500	560
Applicable motor power KW		220	250	280	315	355	400	450	500	560
Applicable motor horsepower HP		300	340	380	430	485	545	615	680	760
output	Rated output capacity KVA	280	355	396	445	500	565	630	700	780

	Rated output current A	426	465	520	585	650	725	820	910	1020
	Output frequency Hz	0.01--400Hz								
	Carrier frequency range KHz	1--16KHz								
	Overload capacity	150% of rated output current, can withstand 60S								
		200% of rated output current, can withstand 3S								
input	Input current A	430	468	525	590	665	785	883	940	1062
	Input voltage frequency	AC:three-phase 380V.50/60Hz								
	Permissible voltage fluctuations	(-15%--+15%)								
Cooling system		Forced cold air								

По вопросам продаж и поддержки обращайтесь:

Алматы (727)345-47-04
Ангарск (3955)60-70-56
Архангельск (8182)63-90-72
Астрахань (8512)99-46-04
Барнаул (3852)73-04-60
Белгород (4722)40-23-64
Благовещенск (4162)22-76-07
Брянск (4832)59-03-52
Владивосток (423)249-28-31
Владикавказ (8672)28-90-48
Владимир (4922)49-43-18
Волгоград (844)278-03-48
Вологда (8172)26-41-59
Воронеж (473)204-51-73
Екатеринбург (343)384-55-89

Иваново (4932)77-34-06
Ижевск (3412)26-03-58
Иркутск (395)279-98-46
Казань (843)206-01-48
Калининград (4012)72-03-81
Калуга (4842)92-23-67
Кемерово (3842)65-04-62
Киров (8332)68-02-04
Коломна (4966)23-41-49
Кострома (4942)77-07-48
Краснодар (861)203-40-90
Красноярск (391)204-63-61
Курск (4712)77-13-04
Курган (3522)50-90-47
Липецк (4742)52-20-81

Магнитогорск (3519)55-03-13
Москва (495)268-04-70
Мурманск (8152)59-64-93
Набережные Челны (8552)20-53-41
Нижний Новгород (831)429-08-12
Новокузнецк (3843)20-46-81
Ноябрьск (3496)41-32-12
Новосибирск (383)227-86-73
Омск (3812)21-46-40
Орел (4862)44-53-42
Оренбург (3532)37-68-04
Пенза (8412)22-31-16
Петрозаводск (8142)55-98-37
Псков (8112)59-10-37
Пермь (342)205-81-47

Ростов-на-Дону (863)308-18-15
Рязань (4912)46-61-64
Самара (846)206-03-16
Санкт-Петербург (812)309-46-40
Саратов (845)249-38-78
Севастополь (8692)22-31-93
Саранск (8342)22-96-24
Симферополь (3652)67-13-56
Смоленск (4812)29-41-54
Сочи (862)225-72-31
Ставрополь (8652)20-65-13
Сургут (3462)77-98-35
Сыктывкар (8212)25-95-17
Тамбов (4752)50-40-97
Тверь (4822)63-31-35

Тольятти (8482)63-91-07
Томск (3822)98-41-53
Тула (4872)33-79-87
Тюмень (3452)66-21-18
Ульяновск (8422)24-23-59
Улан-Удэ (3012)59-97-51
Уфа (347)229-48-12
Хабаровск (4212)92-98-04
Чебоксары (8352)28-53-07
Челябинск (351)202-03-61
Череповец (8202)49-02-64
Чита (3022)38-34-83
Якутск (4112)23-90-97
Ярославль (4852)69-52-93

Россия +7(495)268-04-70

Казахстан +7(727)345-47-04

Беларусь +375-257-127-884

Узбекистан +998(71)205-18-59

Киргизия +996(312)96-26-47

эл.почта: agy@nt-rt.ru || сайт: <https://laeg.nt-rt.ru>